

Miniature:U  
ミニファクトリー

# Dream Wedding

Instruction manual



Before beginning to make...

1. Please prepare your own tools for building (needle, scissors, cutter, tweezers, etc.)
2. Please be sure to use the correct materials when cutting to avoid mistakes.
3. By cutting the pattern papers first the corresponding numbers may be cut off, so please be careful.
4. Please be aware that the color of the materials may differ from the photos in this manual.
5. An adult should be present if children are building.

6. For best results in preparing the fabric patterns, first place the paper on the fabric and draw a line around it to assist cutting.



7. How to perform the running stitch  
Insert the needle from 1, take it out of 2, insert from 3, and take it out of 4. Repeat this.

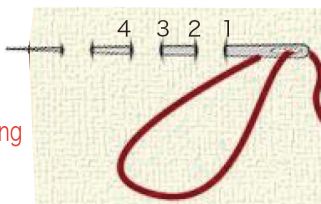

Please take proper care in handling the needle.

8. Please test the operation of the LED light bulbs (B5) by referring to the image below.

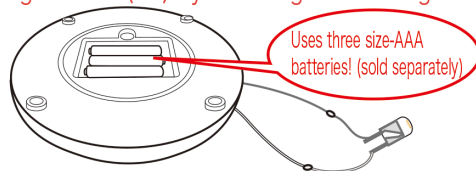

**DO NOT** connect the cords directly to the batteries.

Lighting tests require connecting to the bottom of the pedestal of the B2 pedestal set. Please prepare batteries and a screw driver. **Connect the cords with the same colors.**

**Warning** DO NOT plug any of the cords into power outlets.

## Contents of Bag A

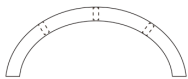

A1 Wooden part  
6.5 x 2.5 x 0.5cm (1)



A2 Wooden parts  
6.1x0.5x0.5cm (2)



A3 Wooden part  
6x2.5x0.3cm (1)



A4 Wooden part  
1x1x3cm (1)



View from above



Side view

A5 Wooden parts  
1x1x0.3cm (2)



A6 Wooden parts  
1.3x0.8x0.1cm (2)



A7 Wooden parts  
1.3x0.6x0.1cm (2)



A8 Wooden part  
2.1x2.6x0.1cm (1)

## Contents of Bag B



B1 Part outline sheet  
(1)

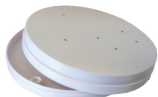

B2 Pedestal set (1set)



B3  
Transparent dome  
(1)



B4 Screws  
(5)



B5 LED lights  
(7)



B6 Protection sticker  
(1)



B7  
Glue  
(1)



B8 Crown  
(1)



B9 Cake (pink)  
(1)



B10 Cake(white)  
(1)



B11 Candy  
(1)



B12  
Plant  
(1)



B13  
Donut  
(1)



B14 White thread, 2m(1)  
※In Bag C



B15  
Mannequin  
(1)  
※In Bag C

## Contents of Bag C



C1 White cable  
25cm (1)



C2 Gold cable  
70cm (1)



C3 Black cable  
25cm (1)



C4 Gold ball chain  
40cm (1)



C5 Silver ball chain  
40cm (1)



C6 Torus A  
(8)



C7 Torus B  
(2)



C8 Torus C  
(1)



C9 Transparent parts A,  
(3)



C10 Transparent parts B  
(2)

# Contents of Bag C



C11  
Transparent  
flower part  
Large (1)



C12  
Transparent  
flower  
part, Small (1)



C13  
White flower parts  
(16)



C14  
Pink flower  
parts (2)



C15  
Transparent  
bead  
(1)



C16 Pearl beads, Small  
Pink (5)



C17 Pearl beads, Small  
Dye color (2)



C18 Pearl beads, Small  
Pink (2)



C19 Pearl beads, Small  
Thin light blue (2)



C20  
Pearl beads  
Small  
light pink (5)



C21  
Ball parts, Small  
Black (6)



C22  
Ball part, Large  
Black (1)



C23  
Transparent  
stone  
(1)



C24  
Purple jewel  
(1)



C25  
Pink mesh  
15 x 30cm (1)



C26  
Rhombic mesh  
7 x 7cm (1)

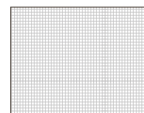

C27  
White mesh  
21x9cm (1)



C28  
Honeycomb mesh  
15x11cm  
(1)



C29  
White cloth  
14 x 19cm  
(1)



C30  
Gold cloth  
9x11cm (1)



C31  
White cardboard  
8 x 8cm (1)



C32  
Corrugated cardboard  
White  
8 x 8cm (1)



C35 Embroidered lace  
20cm (1)



C33  
Grass sheet  
13 x 13cm (1)



C34  
Gold paper  
6 x 6cm (1)



C36  
Flower lace  
(3)



C37 White ribbon  
30cm (1)



C38 Silver ribbon  
6cm (1)



C39 Lace ribbon  
10cm (1)

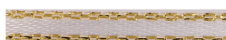

C40 Gold-edged ribbon  
70cm (1)



C41  
Red berries  
(2 bunches)

# Building process

## Gift Box

♥ Using Gift Box ①②&③ of the C32 pattern paper, cut C32, curl it around to match B1-6, and glue it.

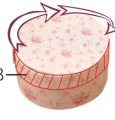
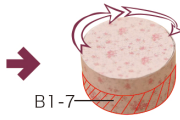
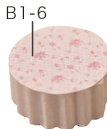
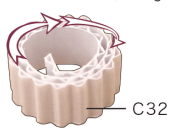

♥ Similarly make Gift Boxes ②&③.

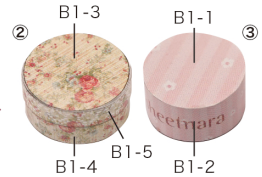

♥ Cut out B1-1 to B1-8 with the pattern papers.

That completes the Gift Box.

## Candy Plate

♥ Using the pattern papers, cut out C31 and B1-15 together and glue them. Glue C5 around the edge.



♥ Glue together B11 and C1. Make six candies. Glue on two balls of C4 and the candy.

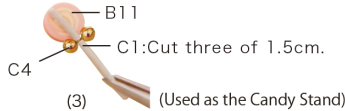
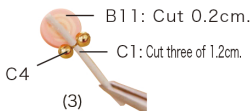

That completes the candy plate.

## Candy Stand

♥ Cut out B1-9 curl and glue it.

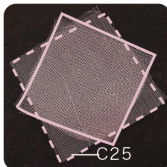

That completes the candy stand.

# Cake Stand

♥ Cut out C31 and B1-11 to B1-13 with the pattern papers and glue them together.

♥ Cut out C32 with the pattern papers and glue on the periphery of C31. Cut off any extra length.

♥ Similarly do for the middle and upper stages.  
※B1-11~B1-13  
Leave a hole in the center

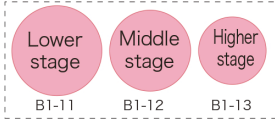

♥ Cut out B1-10 with the pattern papers and glue onto the side.

♥ Similarly do for the middle and upper stages.

♥ Cut off 5cm of C1 and bend its tip like in the image below.

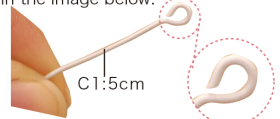

♥ Stick the upper stage through C1.

♥ Stick on and glue, in order, C13, C10 and C13.

♥ Stick on the middle stage and glue on C13.

♥ Stick on and glue, in order, C13, C10 and C13.

Higher stage

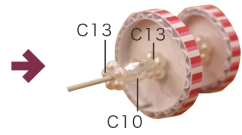
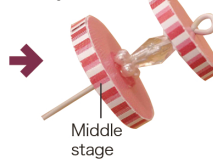
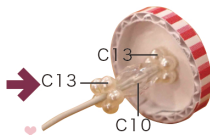

♥ Stick on the lower stage and glue on C13.

♥ Bend the extra part of C1 at a right angle and glue it on.

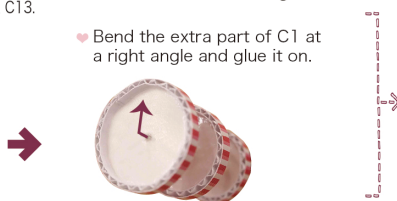

That completes the cake stand.

# Sweets

## Cake A

♥ Cut B9 into four 3mm-thick pieces.  
Cut out C34 with the pattern paper and glue in the center of the silver surface. Bundle it up with C34 and glue on C6.

## Cake B

♥ Cut B10 into four 3mm-thick pieces.  
Cut out C34 with the pattern papers and glue in the center of the gold surface. Bundle it up with C34 and glue on C6.

## Lolly Pop Chocolates

♥ Cut C1 into five 1.2cm-thick pieces. Cut five pairs of balls from C4. Glue C1 and C20 together. Glue C4 to C20.

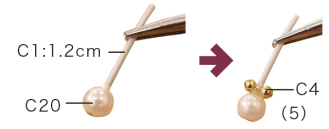
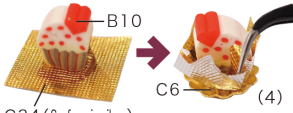

C34 (Surface is gold) That completes the cake A(4)

C34 (Surface is silver) That completes the cake B(4)

That completes the Lolly Pop Chocolates(5)

## Mesh Ribbon

♥ Cut out C27 with the pattern paper. With a double strand, sew a running stitch through the middle of C27.

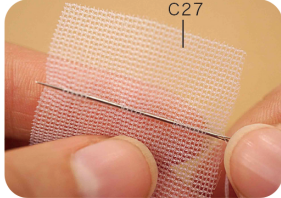

♥ Just before the thread knot, pass the needle between the threads.

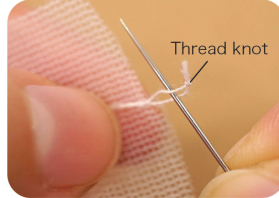

♥ Tighten the thread to make the squeezed ribbon shape below.



♥ Stitch through the squeezed part two to three times.

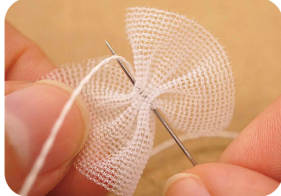

♥ Lastly make a French knot to keep the ribbon shape.

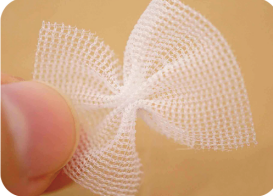
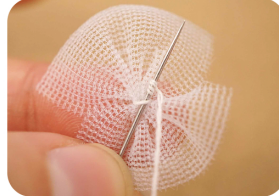

The completed mesh ribbon.

## Table

♥ Glue A4 in the center of A3. That completes the table base.

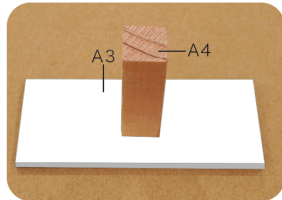

♥ Cut out C29 with the pattern paper, and glue to the table base.

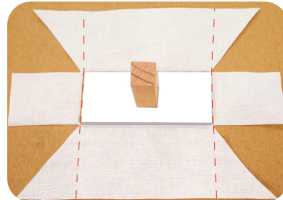

♥ Glue the triangular parts to the side faces of the table cloth.

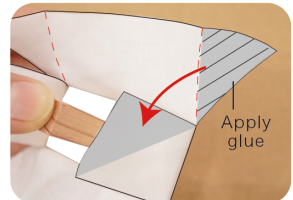

♥ Similarly, on the opposite side, layer and glue the side faces of the table cloth.

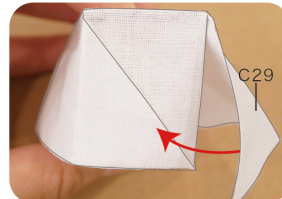

♥ Similarly, also glue the sides of the table's other side.

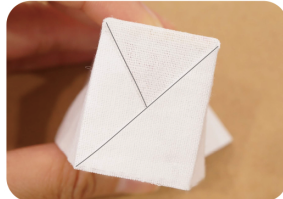

♥ That completes the table.

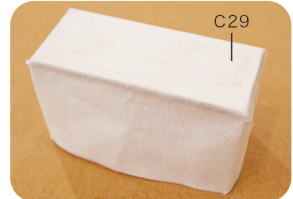

## Table Ornaments

♥ Cut out C30 with the pattern paper, and glue onto the table.

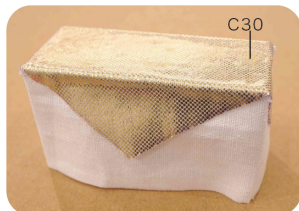

♥ Cut C37 into four pieces of 7cm, and glue them to the edge of the table cloth.



♥ Glue on the mesh ribbon created on page 6.



♥ Cut off 10cm of C39, tie it in a bow, and glue it on top of the mesh ribbon.

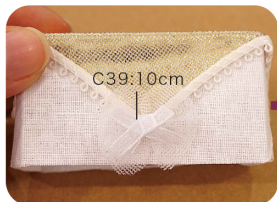

♥ Glue C14 on top of the C39 bow.



♥ Cut off three 10cm strands of C40, tie them each in a bow, and glue one on the opposite side of the table, and the other two each on the short-end sides of the table.



♥ Cut off single balls from C4 to glue to C37. When gluing, leave two loops between each one.

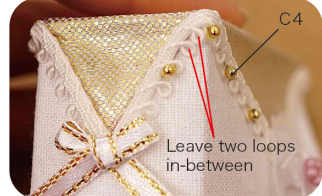

♥ Glue on the singular C4 balls all the way around C37.

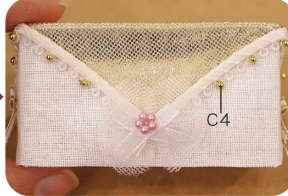

That completes the table ornaments.

## Chocolate Stand

♥ Cut out six C34 with the pattern paper, and wrap up a C21 with each of them.

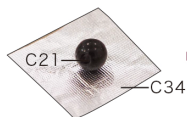

♥ Cut off any extra part and wrap it up. That completes six chocolate balls.



♥ Glue C11 and C12 together. That completes the plate for the chocolates.



♥ Glue each part to Gift Box ①.



That completes the chocolate stand.



## Table setting

- Using the pattern papers, glue the cake plates and B1-14 to C31. That completes eight cake plates.

### Higher stage

- Glue on the Lolly Pop Chocolates.



### Middle stage

- Glue on the Cake As to the cake plates and glue them to the middle stage.



B1-14

- Cut out B1-18 with the pattern paper to make the Card Stand.

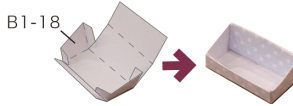

### Lower stage

- Glue on the Cake Bs to the cake plates and glue them to the lower stage.



B1-14

- Glue on each of the parts.



That completes the table setting.

## Bouquet

- Cut out C26 with the pattern paper. Fold C26 like an accordion with 1cm intervals, fold it in two across the middle, and pass through C2.

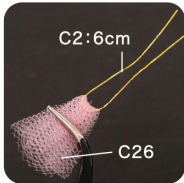

- Make the length of both sides of C2 equal and twist it together, then pass through and glue on C16.

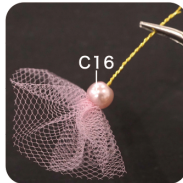

- Open up C26.

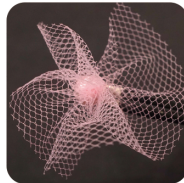

- Glue four C16s to C26.

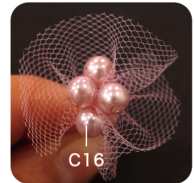

- Glue on two each of C17, C18 and C19, and eight of the singularly-cut C5.



- Cut off 2cm from C40, bend it and glue the two edges together. Make six.



- Glue the six C40s to the underside of C26.



That completes the bouquet.

- On the underside, cut C2 to an appropriate length.

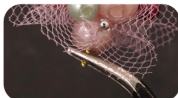

# Wedding Dress

♥ Cut out both C31 and C32 with the pattern papers and glue them together with C32 on the periphery of C31.

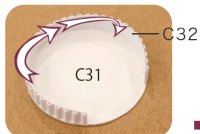

♥ Glue B15 to the mannequin stage. Cut out two V-shapes from the mannequin stage as shown below.



♥ Cut out C29 with the pattern paper, and apply glue to the gluing tabs.



♥ Curl around and stick C29 to B15.

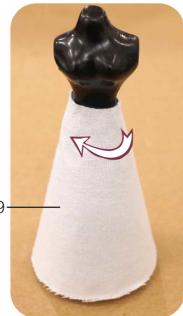

♥ Glue on the rest of C32.



Mannequin stage

♥ Apply glue to the area just below the waist of B15.



♥ Cut C36 like in the image.

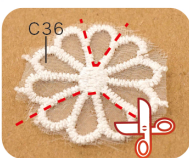

♥ Glue C36 to the front of B15.



♥ Glue it completely up to the edges. (Front)



♥ Glue to the edge (back)



♥ Cut out C27 with the pattern paper and layer it on top of C35 aligned with the black line. Sew a running stitch with 0.4cm intervals 5.5cm away from the black line to sew the two layers together. After that, cut along the red line.

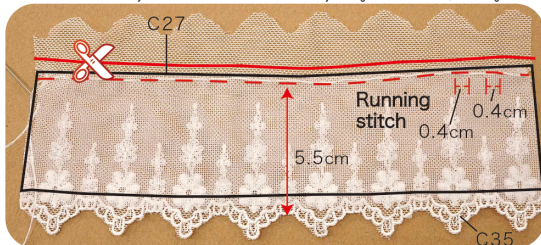

♥ Pull the thread to squeeze it. That completes the dress skirt.



♥ Wrap the dress skirt around the waist of B15 and sew its edges together.



♥ Glue both edges of the dress skirt.



♥ Cut the protruding parts of the dress skirt.

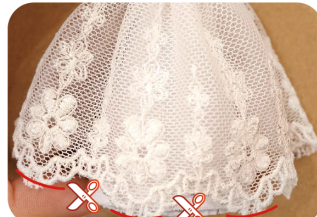

That completes the wedding dress.

# Wedding Dress Ornaments

## Ribbons (4)

♥ Cut C40 into four 3cm pieces.



♥ Wind C40 around a pen or similar object and glue its edges together. Take it off the pen and fold into two.



♥ Cut off 3cm of C2 and pass it through the fold of C40.

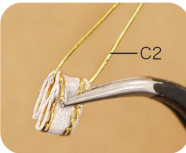

♥ Wind C2 around once and tighten it hard.



♥ Cut off the extra parts of C2. That completes the ribbons (4).



♥ Matching where the embroidered flowers are on the dress, glue on C13 alternately at higher positions and lower positions like in the image. (Total 8 pieces)



♥ Glue the ribbons on top of the lower-positioned C13s. (Total 4 pieces)



## Mesh ribbon

♥ Cut out C28 with the C28 pattern paper to make the mesh ribbon.



\* For how to make the mesh ribbon, refer to page 6.

The completed mesh ribbon.

♥ Glue the C28 mesh ribbon to the back of the dress skirt.



♥ Glue C4 (in pairs of balls) onto the dress skirt aligned with the rise and fall of its hem. (Total 15 pairs)

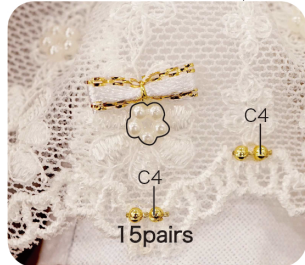

♥ Glue C4 (singular balls) in the center of the dress skirt's flower patterns. (Total 4 pieces)

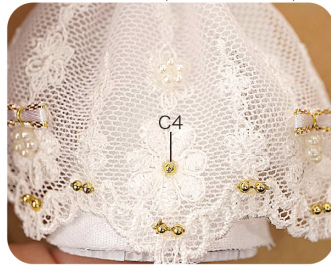

♥ Cut off 10cm of C40 and tie it in a bow. Glue C4 (7cm) and C40 to the mesh ribbon.



♥ Cut a part of the C7 periphery and cut out the whole inside part.



♥ Glue C7 around the neck, and glue C24 on to it at the front. Cut off 6cm of C38 and glue it around the waist. Cut off any extra part.

### Lift the dress skirt to put inside the LED.

♥ Bend and glue the B5 cords into the V-shaped cuts of the mannequin stage.

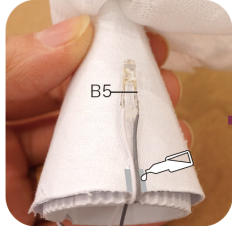

♥ Bend the B5 cords at the base and also glue them on.



♥ Glue C13 to the top of C28.



That completes the wedding dress ornaments.

♥ Cut out C28 with the pattern paper. Make a valley fold along the folding line of the pattern paper and glue.

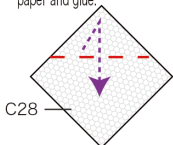

♥ Glue C28 to the top of C22.



## Lantern

♥ Pass B5 through the hole of A5 and glue it.

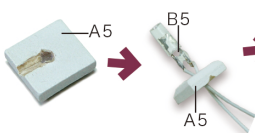

♥ Trail the cord through the groove on the bottom.



♥ Assemble together and glue two each of A6 and A7.

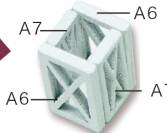

♥ Glue on top of A5.

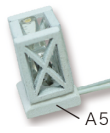

♥ Glue A5 and C23 on top.

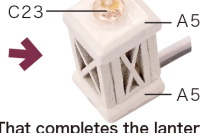

That completes the lantern.

## Preparing the pedestal

♥ Cut C33 to match the top part of B2, and glue it on.

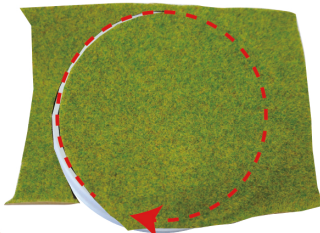

♥ On the underside, make holes at the below points.

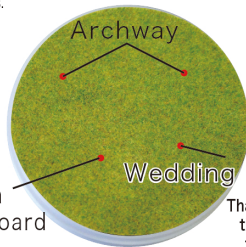
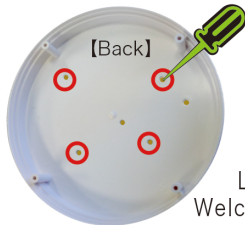

Lantern  
Welcome Board

That completes  
the preparing  
the pedestal.

# Welcome Board

♥ Cut two 4cm pieces of C3.  
Curve them like in the image.

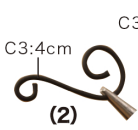

♥ Cut an 8cm piece of C3.  
Curve it like in the image.

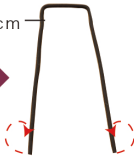

♥ Cut an 5cm piece of C3.  
Curve it like in the image.

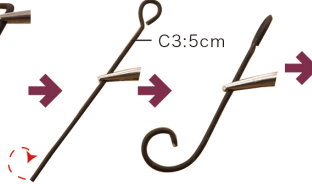

♥ Glue A8 and B1-20 together.  
Also glue on C3.



♥ Adjust the length of the legs before gluing them to avoid the board being unsteady.

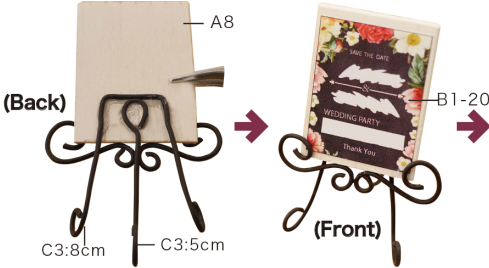

♥ Bend the B5 LED at its joint.

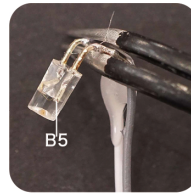

♥ Cut out C26 with the pattern paper.  
Make a mesh ribbon as on page 6.

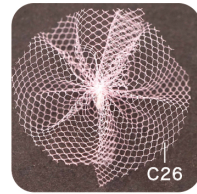

♥ Glue on B5.



♥ Glue the B5 cord to the back side.

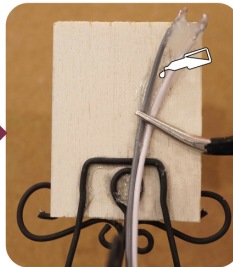

♥ Cut seven leaves from B12.



♥ Glue on the seven leaves from B12.

♥ Write the names and date of your liking.

♥ Glue on C15 to be a cover for the LED.



♥ Glue on C14, C26 and C41.

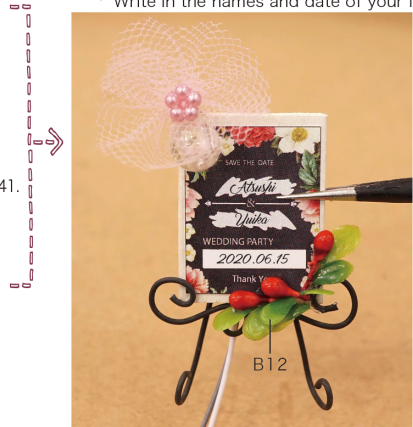
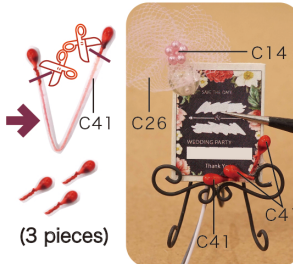

That completes the welcome board.

# Archway

♥ Cut out a 0.8 x 2cm piece of B6 and wrap it around the roots of two B5s bundled together.

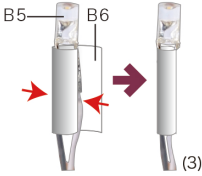

♥ Attach A1 to A2.

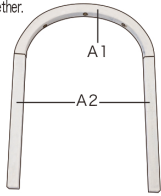

♥ Pass three B5s through the holes of A1.



♥ Cut out C25 with the pattern paper, fold it like an accordion, and tighten together the center line part with C2. (2 pieces)

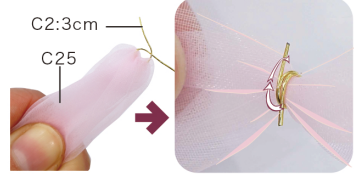

♥ Glue C25 to the center of A1.



♥ Have two glued to both the front and back of the arch.

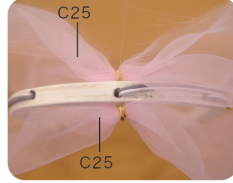

♥ Cut out C2 of 6cm.



♥ Tie A1 and C25 together with C2.



♥ Similarly tie it at six different places and cut off the extra cloth at the same lengths.



♥ Cut two 3cm pieces of C5 and glue them on.



♥ Cut two 5cm pieces of C5 and glue them on.

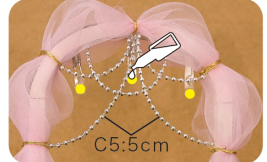

♥ Cut a 5cm piece of C5 and glue it on.



♥ Glue C9 to C2 so that it overlaps the LED.

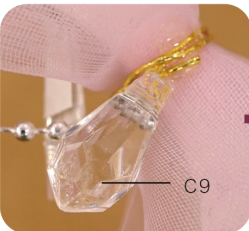

♥ Attach C13 to C9.



♥ Do the same for all three LEDs. Glue B8 to the one on top.

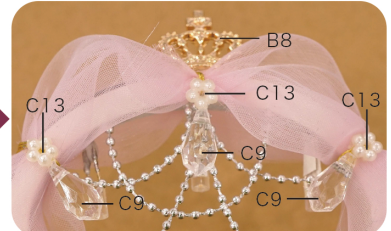

That completes the archway

# Pedestal Setting

♥ Pass the cords for the archway through the holes in the pedestal and glue in the archway and table.



♥ Pass the LED cords of the wedding dress through the holes in the pedestal, and apply glue to them on the underside of the mannequin stage.



♥ Lightly pull the cords from under the pedestal, and glue on the wedding dress.



♥ Pass the lantern cords through the holes in the pedestal, and glue on the lantern and its cords.



♥ Pass the welcome board's cords through the same hole as for the lantern, and apply glue to the three legs of the board.



♥ Glue in the welcome board.



♥ Glue the bouquet in front of the welcome board.



♥ Glue the candy stands in front of the arch at the back.



# Cord Wiring

- ♥ Gather together the B5 cords by color, and connect them to the B2 cords of the same color. Cut off 2cm pieces of B6 to wrap around the connected areas.

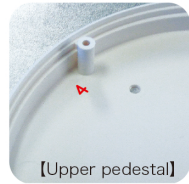
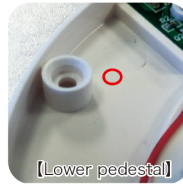
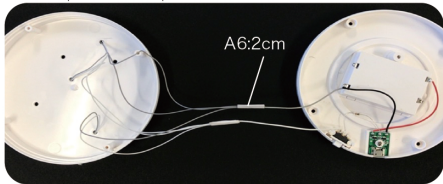

- ♥ Bring together the two pedestal parts so the screw hole of the lower pedestal with a circle sign matches the No. 4 screw hole of the upper pedestal. Fasten the screws in four places of the pedestal.



Power switch      microUSB port (USB Micro-B)

- ♥ Power switch  
Uses three size-AAA batteries. If using batteries, please turn on/off with the power switch.
- ♥ microUSB port (USB Micro-B)  
Connect main unit and external power device with a USB port with microUSB cable. Input voltage/Current:DC5V/1~2.4A



## Completed image



## Wedding Dress



## Cake Stand



## Candy Box



## Welcome Board

